

FOR AGES
14+

FOLDABLE DRONE



2.4GHz
EDITION

Please read the instructions carefully before use (Please read carefully for details and warnings) Save this manual for future reference

Important safety information

- (1) The product is not a toy, but the mechanical, electronic, aerodynamics, high-frequency transmission and other professional knowledge into one of the fine Dense equipment, it needs for proper assembly and commissioning to avoid accidents. The product holder must use a safe way, Operation control: improper operation, may cause serious personal injury or property damage. We are not responsible for this, Because we can not control the assembly, use, operation process.
- (2) This product is suitable for people who more than 14 years old with operating model experience.
- (3) The flight site must be a local legal drone flight site
- (4) Once the product is sold, we will not be responsible for any accident arising from operation and use, control, etc.
- (5) If you have any question about using, operating and measuring the drone, please contact local distributors, and we have assigned those distributors to provide technical support and after-sales service.

2. Safety Precautions:

The drone is a high-risk good, it must be away from the crowd when flying. Artificial assembly or damage, electronic control or the improper operation which not allowed, all of them are likely to cause damage to the aircraft, personal injury or other unpredictable accidents. Pilots must be careful, and need to understand the responsibility of accident which due to their own negligence.

(1) Away from obstacles and crowds

The flying drone has an uncertain flight speed and state, there is a potential risk. Fly away from the crowds, high-rise buildings, high-voltage wires, etc., meanwhile, avoiding flying in windy, rainy, thunderstorms and other bad weather to ensure the safety of pilots, the surrounding population and the property.

(2) Away from the damp environment

The interior of the drone is made up of many sophisticated electronic components and mechanical parts, so it is necessary to prevent the aircraft from wet or let water into the body, so as to avoid mechanical, electronic components accidents.

(3) Safe operation

Please operate the drone according to your own status and flight skills. Fatigue, poor spirit or improper operation will increase the risk of accident.

(4) Keep away from high-speed rotating parts

When the propellers are in the high-speed spinning, please keep the drone away from pilot, the surrounding, crowd and objects to avoid danger and damage.

(5) Keep away from heat

The drone is composed of metal, fiber, plastic, electronic components, and other materials, so keep it away from heat, prevent sunshine, drying to avoid deformation caused by high temperature.

The drone is made of lithium polymer battery (LiPo)

Lithium batteries are different from the general battery, which consists of a thin layer of thin paper wrapped with its chemical endoplasm. Which reduce its weight, but makes it more vulnerable in the face of rough or inappropriate operations. The inappropriate operation of this battery will cause a explosion.

- Do not put the battery in the drone while charging, which may cause the battery fire and damage.
- Please use the original professional charger to charge the battery.
- Do not charge the battery on the carpet to prevent fire.
- Charging Lithium battery to maintain the voltage to ensure it is useful after storage for more than three months.

Battery Charging Instruction and Installation for the Drone and Remote Controller:

Remote control battery installation:

3 AA Batteries (Not Included)

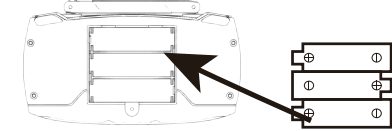

The drone battery:

1. Charging the battery for the drone

The battery of the drone charges by the USB charging cable. (Included in the Package) The indicator light on the USB cable remains on while the battery is being charged.

The indicator light goes off when the battery is fully charged.

2. Connect the battery with the drone: Place the battery into the battery holder and connect it with the drone.

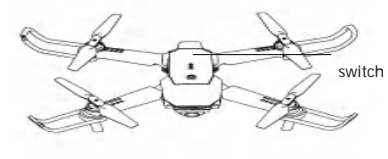
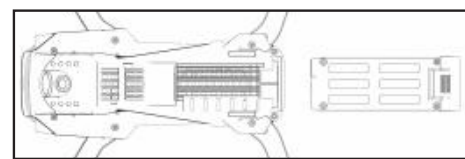

Drone Installation:

1. Folding procedure

1) Back Arms. 2) Front Arms.

Expanding Procedure

1) Front Arms. 2) Back Arms



2. Propeller Installation.

Please refer to the picture as shown

Blades A (Left Front Arm & Right Rear Arm)

Blades B (Right Front Arm & Left Rear Arm)

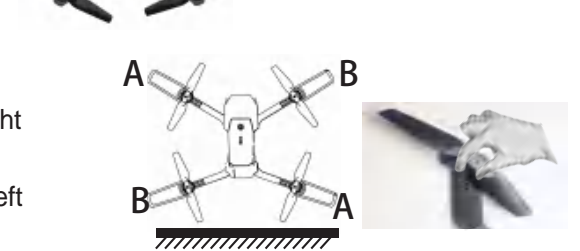

3. Propeller protection shields can be installed by clipping on each side of the propeller arms (No Tools Required)

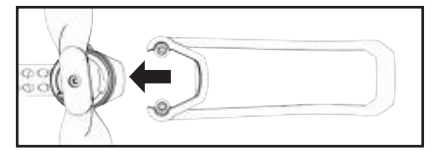

Remote control function introduce

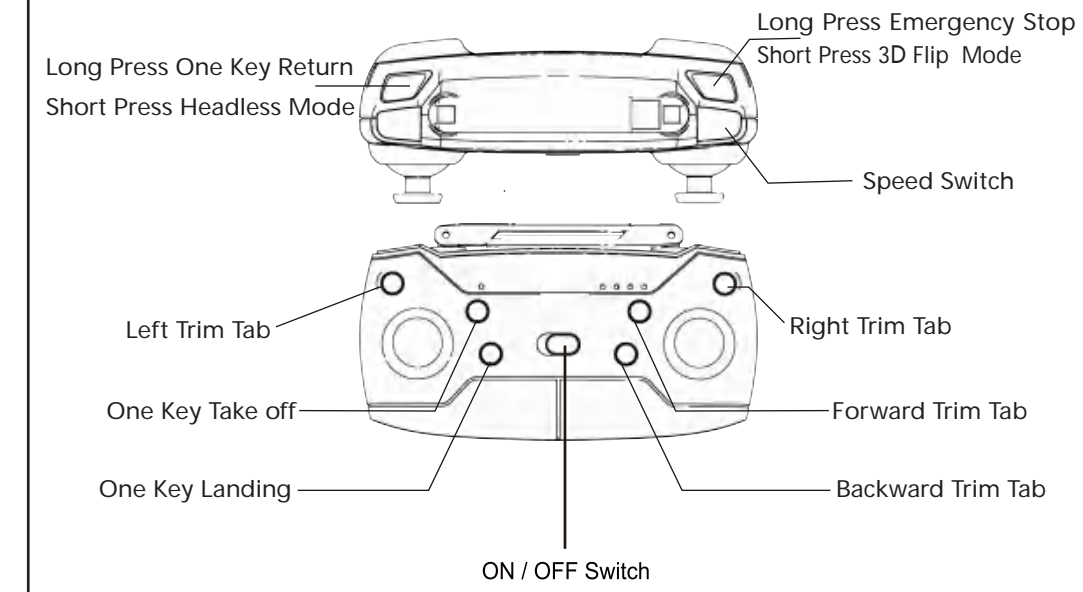

Remote Control:

1. Mobile Phone Holder

Located at the bottom of the remote.

Pull out the phone holder and the phone can be mounted securely with the clamp.

Maximum for 5.5" mobile phones



2. Synchronize the drone with the remote control.

1. Put the drone on a flat surface.

Power On (Turn on the drone first, then turn on the remote)

2. The indicator light of the drone is flashing and is ready to sync.

3. Push the throttle stick up and down rapidly to complete the synchronize procedure.

4. The flashing light will turn solid when the drone and remote is successfully synced.

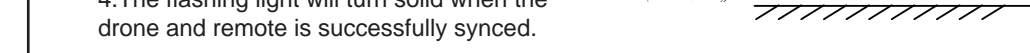

3. Auto Take off and Landing Buttons:

Take off: The drone can take off automatically to about 5 feet high by pressing the One Key Take off button.

Landing: The drone can landing vertically and automatically by pressing the One Key Landing button.



4. Flight Control:

A. Throttle (left lever)

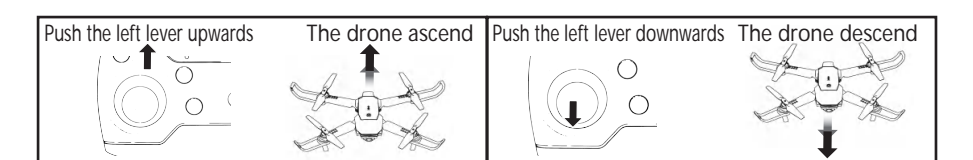

B. Forward and backward (right lever) (with camera front side)

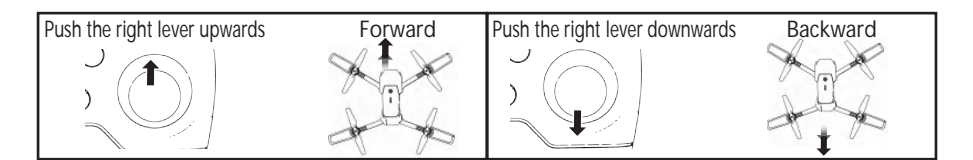

C. Flying Sideways

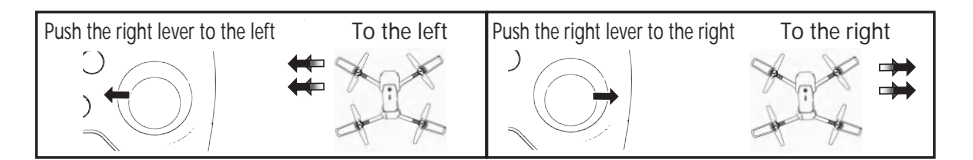

D. Turning

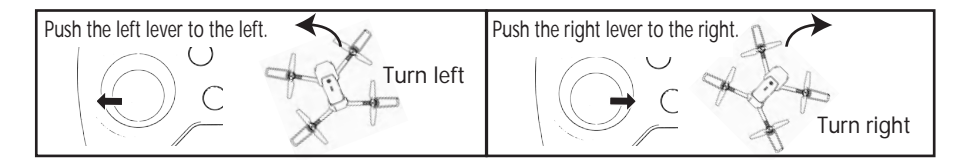

5. Trim Tabs

If your drone drifts slightly in one direction, press the trimmer buttons in the opposite direction.

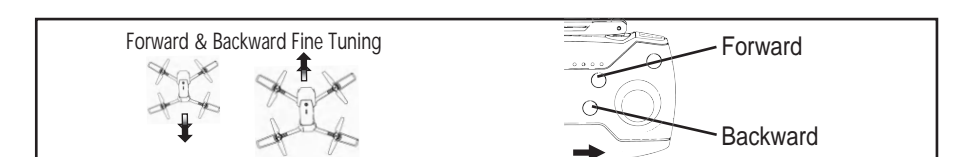

When the drone forward drifts, then press the backward trim tab until it keeps balance.

When the drone backward drifts, then press the forward trim tab until it keeps balance.

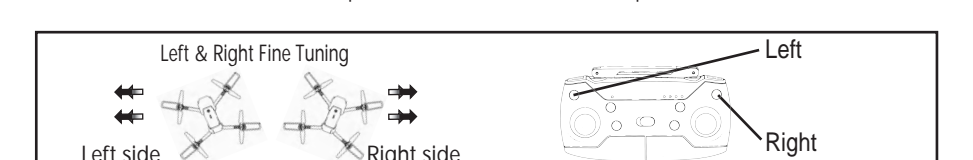

When the drone drifts to the left side, then press the right trim tab until it keeps balance

When the drone drifts to the right side, then press the left trim tab until it keeps balance

Headless Mode:

(Rotation around it's own axis)

Regardless with orientation

(Left is left and Right is Right All the Time)

Regardless of where your drone pointing at.

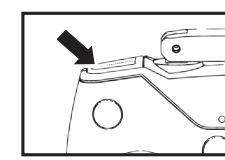

Headless Mode On:

The remote control will "beep" continuously

to notify the headless mode is on until it turns

off by pressing the headless mode button again.

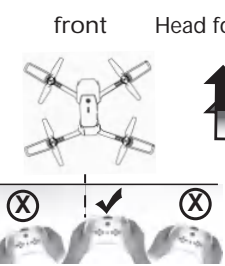

One Key Return:

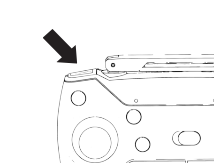

The drone can be returned to the remote

control within 10 feet by press the One Key

Return button.

Speed Selection:

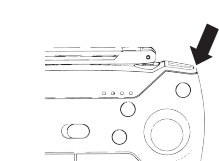

The drone has 3 different speeds to select:

Low speed - original

Medium speed - the first pressing

High speed - the second pressing

Low speed - the third pressing

Reset Setting

The drone can be reset to its original setting programmed

by the manufacturer, when the drone experiencing

unusual and unbalanced flight due to the

motor problem.

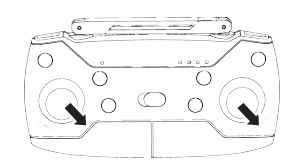

3D Flip

Raise the drone to 2 meters or higher, press

the 3D Flip mode button, then quickly push

the direction lever (right lever) in any direction

you want then release, then the drone will rolling

toward the corresponding direction; press again when you need to exit this function.



Emergency stop

In any case of emergency, the drone can

be shut off during operation to protecting

the motors and surroundings.



Trouble Shooting:

Issues	Facts	Trouble Shoots
Lights of the drone keep flashing	unable to sync	Re-synchronize by follow the synchronized procedure
Indicator lights of the drone are off, not responding after even battery is connected	1. Make sure the battery is connected properly 2. Make sure the battery is fully charged 3. Any damage in the battery or plugs	Recharge or Replace a battery
Lack of power for buffering	Low power	Recharge or replace a battery
Propellers are spinning but unable to take off	1. Low power 2. Propeller damage 3. motor damage 4. Propellers install incorrectly.	Recharge battery, replace propellers or motors if needed.
Excessive Buffering	Propeller damage	Replace damaged propeller
Synchronize the drone successfully, but the remote cannot control the drone, the drone is drift, offset and runaway.		Reset setting the drone and re-synchronize
The phone did not search the Wifi of the drone.		Check the WIFI transmitter of the drone Go to the phone settings, set the WLAN is available with EACHINE FPV app.

Operate By Mobile Device

The app "Eachine FPV" can be downloaded for free to enjoy FPV real time flying



SOFTWARE DOWNLOAD AND INSTALLATION:

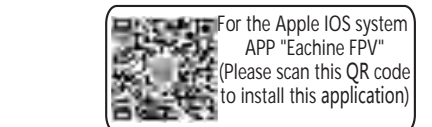

For the Apple iOS system APP "Eachine FPV" (Please scan this QR code to install this application)

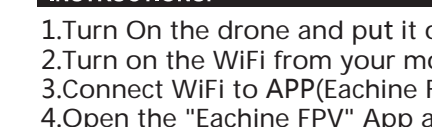

Used for foreign Androids system APP "Eachine FPV" (Please scan this QR code to install this application)

INSTRUCTIONS:

1. Turn On the drone and put it on a flat surface.
2. Turn on the WIFI from your mobile device.
3. Connect WIFI to APP (Eachine FPV) as shown in Figure 1.
4. Open the "Eachine FPV" App after WIFI is connected to (Eachine FPV).
5. Press Play: The camera is on and the FPV picture is displaying on the mobile device.

6. Press the on/off button on the display to synchronize the drone with the mobile device. After the mobile device and the drone are successfully synchronized, the flashing light of the drone will become stable.

7. Press the X button on the display to pop up all the Function Keys.

8. Enjoy your FPV function by operating with the mobile device.



Function Keys:



1. Throttle
- 2.3 Turning Left/Right
- 4.3 Flying Left/Right sideways
- 6.7 Forward/Backward
- 8.9 Forward/Backward Trim
- 10/11 Trim for Left/Right Turning
- 12/13 Trim for Left/Right sideways
14. Take photo
15. Video Recording
16. Media storage
17. Speed selection 30%/60%/100%
18. Motion Operation: by tilting the mobile device Forward/Backward/Left/Right for directional control
19. Function Key Display
20. Show/hide virtual joystick
21. Show/hide settings
22. Reversing the lens (picture can be shown up side down)
23. 3D display
24. Headless mode
25. Reset setting
26. Flying your desired route (By drawing your own route on the display by your fingertip)
27. 360° rolling
28. Emergency stop
29. One Key Take off
30. One Key Landing
31. One Key to unlock

Replacement Parts:



Number	Name	Quantity	Number	Name	Quantity
01	Upper case	1	08	PCB board	1
02	Lower case	1	09	Motors	4
03	Propellers	4	10	Gears	4
04	Front left arm with motor & propeller	1	11	Battery	1
05	Front right arm with motor & propeller	1	12	USB charger	1
06	Rear left arm with motor & propeller	1	13	Camera board	1
07	Rear right arm with motor & propeller	1			